

AYLESBURY

Features

- Solid brass construction
- Complements Aylesbury product series

Double Towel Bar 34-05

Codes / Standards Compliance

Meets or exceeds the following at date of manufacture:

- All applicable US Federal and State material regulations

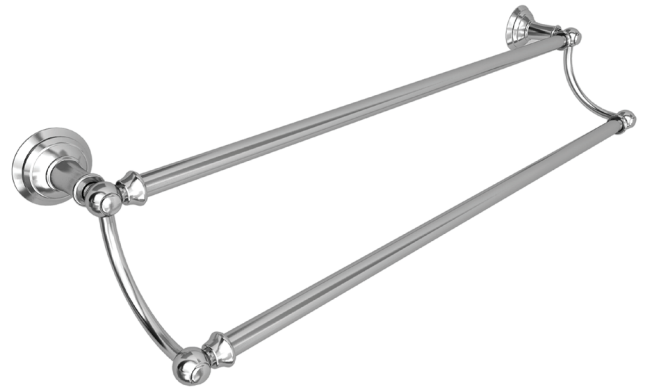

Colors / Finishes

- 10B: Oil Rubbed Bronze
 - 15: Polished Nickel
 - 15S: Satin Nickel - PVD
 - 26: Polished Chrome
- Other: Refer to the Newport Brass catalog for additional color/finish options.

Specified Model

Model	Description	Colors Finishes
34-05	24" Double Towel Bar	<input type="checkbox"/> 10B <input type="checkbox"/> 15 <input type="checkbox"/> 15S <input type="checkbox"/> 26 <input type="checkbox"/> Other

Product Specification Add "Color / Finish" suffix to Model number, below.

The Double Towel Bar shall be made of solid brass construction. Double Towel bar shall complement Newport Brass Aylesbury product series. Double Towel Bar shall be Newport Brass Model 34-05/_____.

34-05

PRODUCT DIMENSIONS *(Units are in inches)*

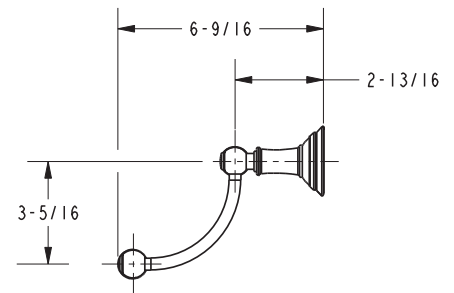
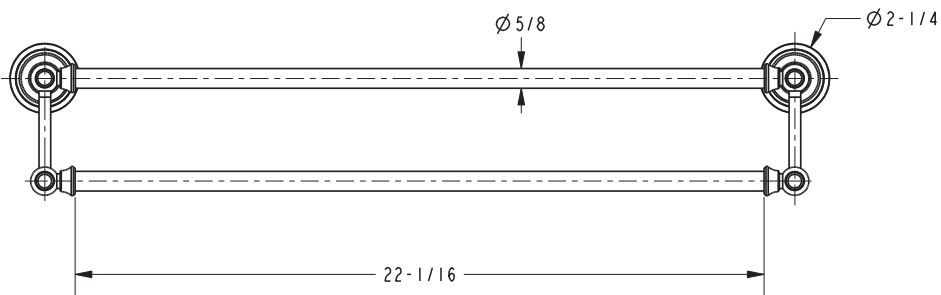
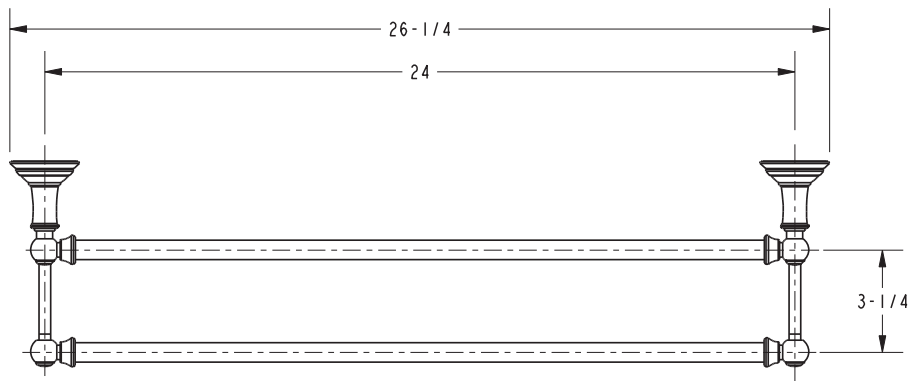

Aylesbury Double Towel Bar 34-05